

1. Wrap the shorter end of the 1/2" IPS nipple with teflon tape covering at least the first three threads; thread sealant is also recommended for any connections in the wall. Insert the nipple to the wall and tighten using the 10mm allen wrench.

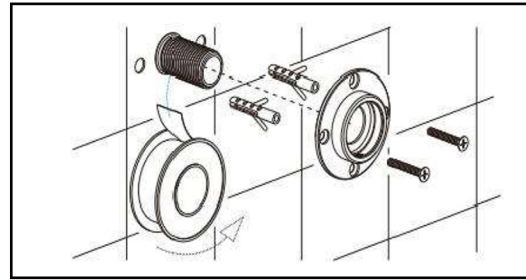

2. Place the mounting plate against the wall and mark out the holes. Using a 6mm drill bit, drill out the holes and insert the plastic anchors (a hammer may be needed to insert fully into wall) Place the mounting base plate over the plastic anchors and mount to the wall using the anchor screws.

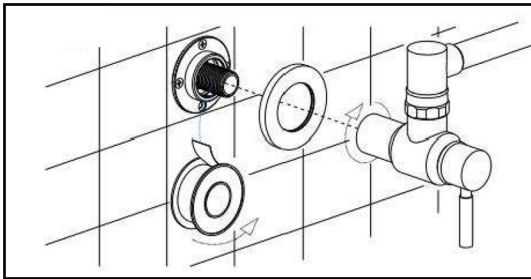

3. Wrap the end of the 1/2" IPS nipple with teflon tape covering at least the first three threads. Place the finish trim plate over the nipple and attach faucet to nipple assuring it is in the correct position .when faucet body is pulled out straight.

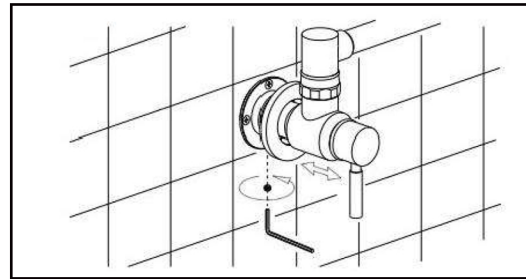

4. Remove the finish trim plate from the mounting base plate and insert the set screw into the bottom of the mounting base plate and tighten. Replace the finish trim plate onto mounting base plate.

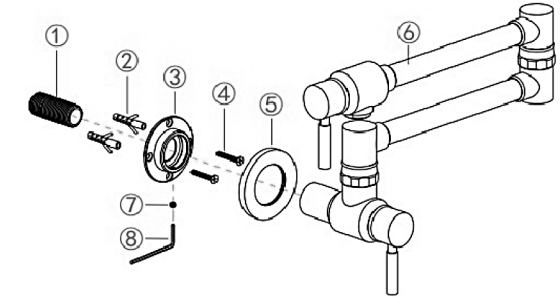

**KCLT0059**

## Part List

Part#	Part	Quantity
1	1/2" IPS nipple	1
2	Plastic anchor	2
3	Mounting base plate	1
4	Anchor screw	2
5	Finish trim plate	1
6	Faucet body	1
7	Set screw	1
8	Allen wrench	1

1. Please verify all parts are present.
2. Before installation, flush cold water line to ensure line is clear of debris.
3. Pictures in the manual are general in content and may not represent exactly your purchased faucet. If you are having difficulties, please contact a professional plumber.