

# PRORECK

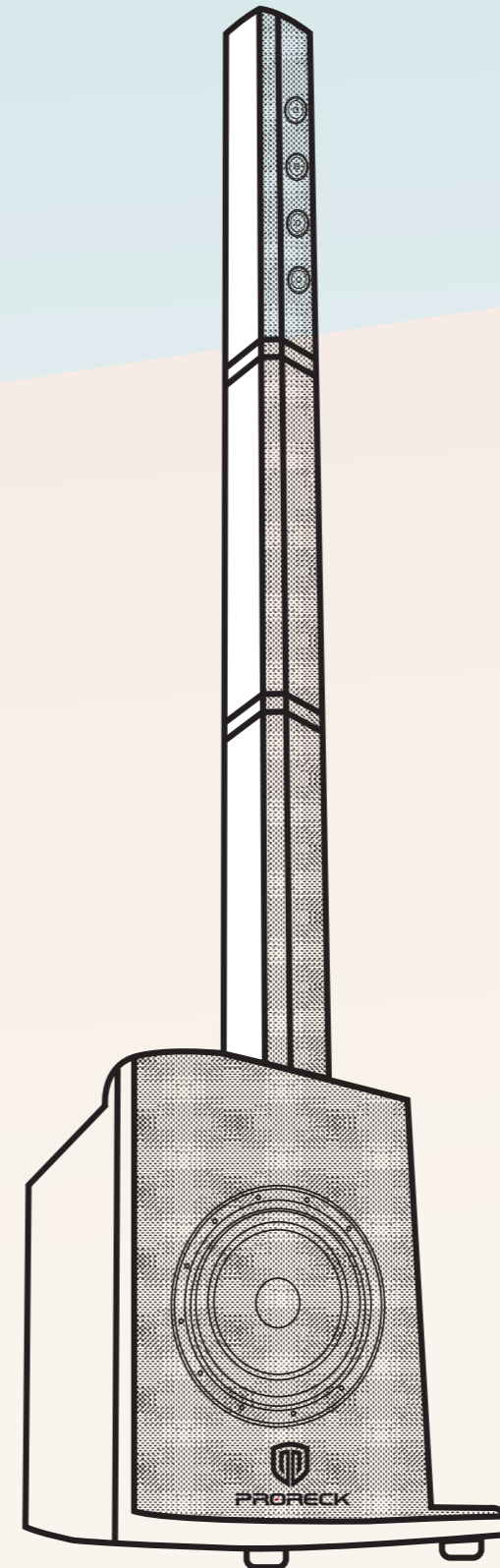

PRORECK AUDIO, INC  
brand@proreck.com  
www.audioproreck.com

# PRORECK



## PARTY 10 USER MANUAL

PRORECK AUDIO, INC  
brand@proreck.com  
www.audioproreck.com

## ASSEMBLY

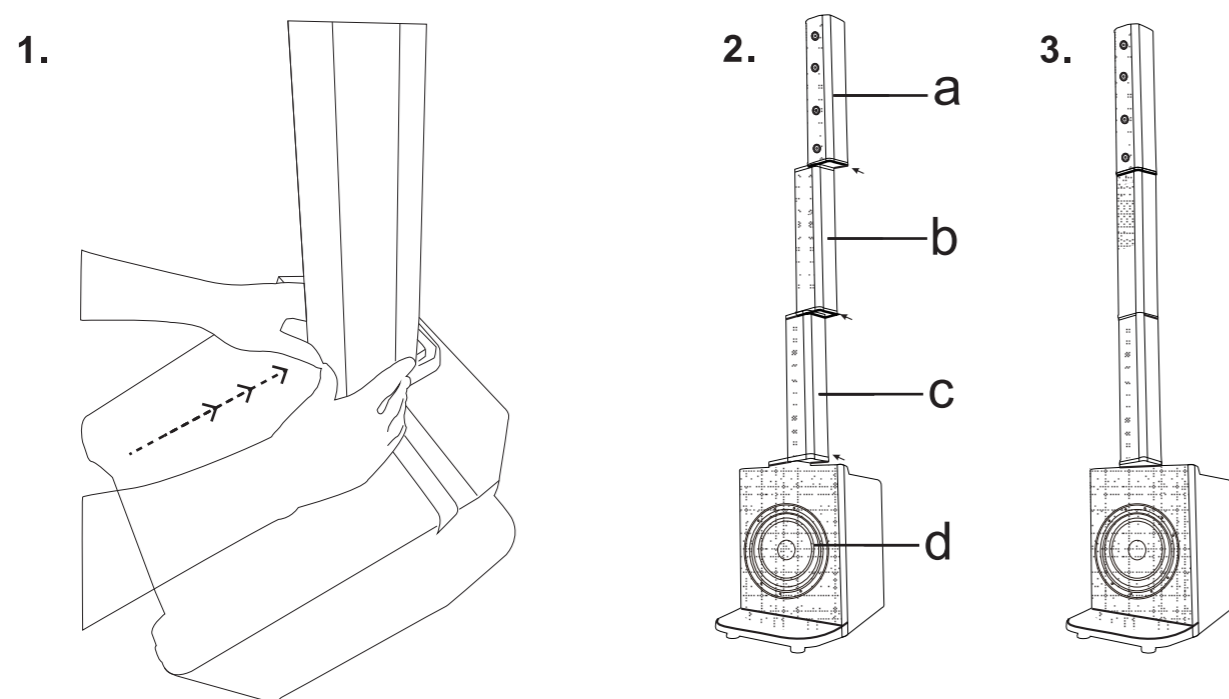

1. Push one column housing (c) to the active sub (d) from the back.
2. Push the second column housing (b) to the first column housing (c) from the back.
3. Push the column speaker (a) to the second column housing (b) from the back.

## DISASSEMBLY

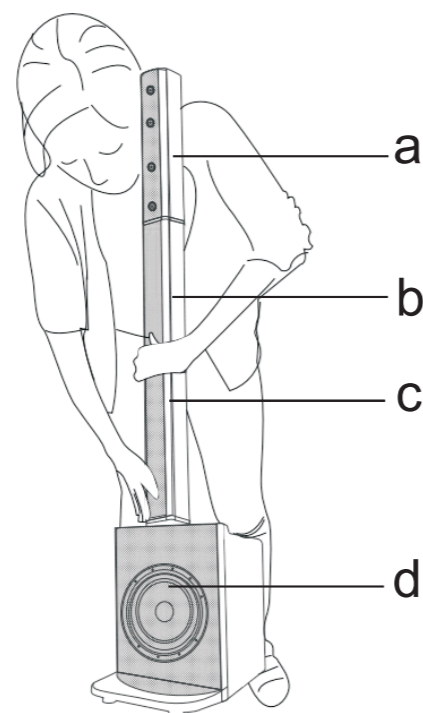

1. To disassemble the speaker system, please hold the column speaker (a) and column housing (b) (c) by one hand, and then gently push out the column housing (c) backward by the other hand.
2. Disconnect the column speaker (a), column housing (b) (c) piece by piece.

## INTRODUCTION

Thank you for purchasing our PARTY 10 pa system. Please read the manual carefully before use and keep it in safe place for future reference. For any questions, please email us at [sales-1@proreck.com](mailto:sales-1@proreck.com).

The portable PARTY 10 speaker system consists of four 3" Mid-high range drivers with a built-in 500 watts amplifier. The amplifier features 3-channel inputs, as well as a digital media player with USB/SD and Bluetooth functions.

## PACKAGE CONTENTS

- 1x Active sub
- 1x Column speaker
- 2x Column housing
- 1x Remote control
- 1x Power cable

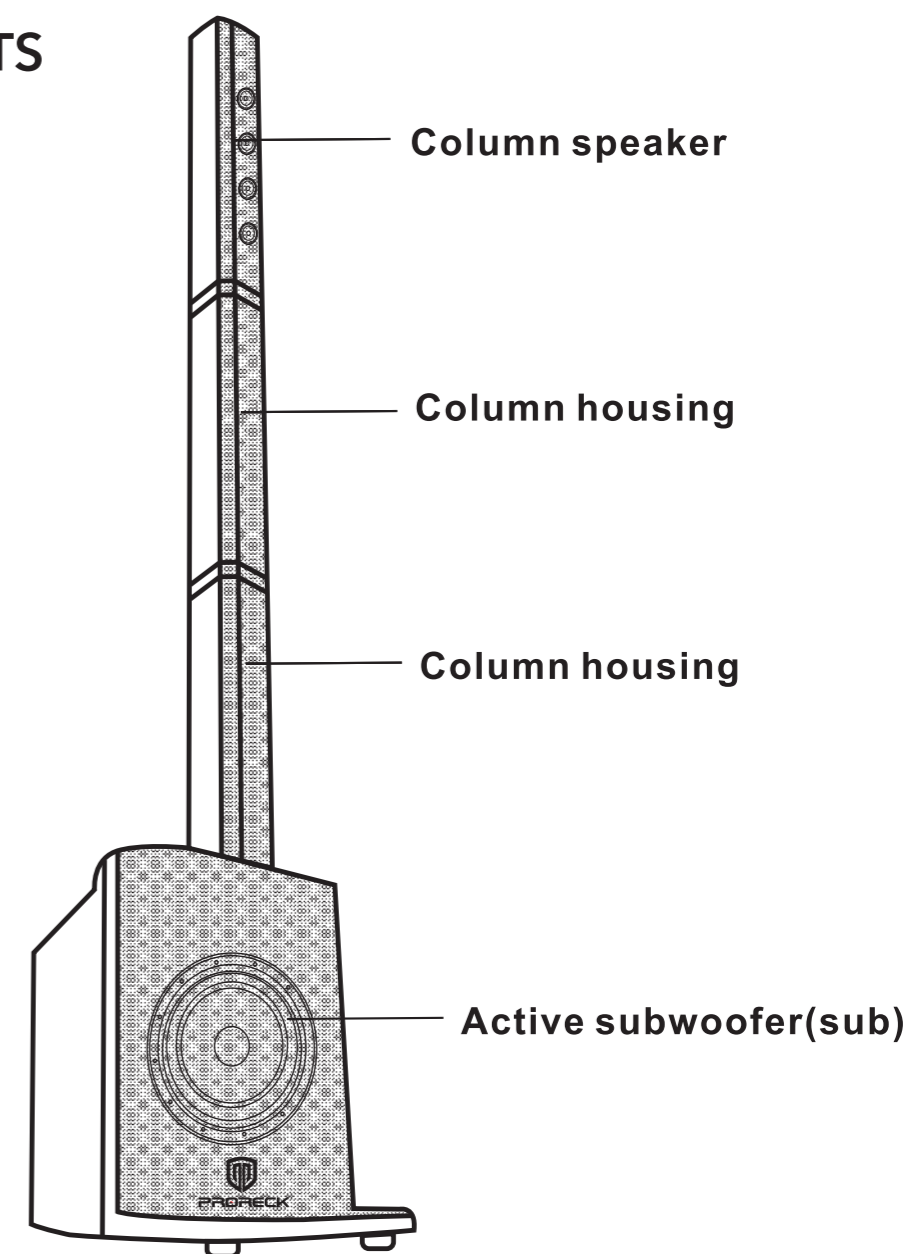

## PARTY 10

## SPECIFICATIONS

Power Output	500 watts
Subwoofer Size	10-inch
Input Connections	USB drive & SD card & Bluetooth & 1/4" Mic Input RCA & XLR Input
Output Connections	XLR Output

## IMPORTANT SAFETY INSTRUCTION

1. Read the instructions carefully before use and keep the manual for further use.
2. Follow all instructions. Improper use may cause damage to the unit.
3. Do not expose the unit to rain or moisture.
4. Do not block any ventilation opening. Install in accordance with the manufacturer's instructions.
5. Do not install near any heat sources, such as radiators, heat sources, stoves, or other units that produce heat.
6. Clean only with a dry cloth.
7. Unplug the unit during lightning storms or when unused for long periods of time.
8. Refer all servicing to qualified service personnel. Servicing is required when the unit has been damaged in any way, such as power supply cord or plug is damaged, liquid has been spilled or objects have fallen into the unit, the unit has been exposed to rain or moisture, operate abnormally.
9. This unit shall not be exposed to dripping or splashing.
10. Do not place objects filled with liquids, such as vases or beer glasses on the unit.
11. Do not overload wall outlets and extension cords as this can result in a risk of fire or electric shock.

**WARNING** RISK OF ELECTRIC SHOCK! DO NOT OPEN.

CAUTION: TO REDUCE THE RISK OF ELECTRIC SHOCK, DO NOT REMOVE COVER (OR BACK).

## GETTING STARTED

The following steps will help you set up the PARTY 10 quickly.

1. Read instructions carefully and check all components are included in the package.
2. Turn down the MIC volume, LINE volume and ECHO.
3. Plug in and turn on the speaker.
4. Connect your devices.
5. Slowly adjust the volume knobs of the corresponding channel to a comfortable listening level.

## LINE IN INSTRUCTIONS



1. Plug in and turn on the power (19) (20).
2. Turn the line volume (13) to the MIN level.
3. Press the MODE button (3) to find "LINE" on the LCD display.
4. Connect the device through XLR or RCA input jack.
5. Turn the line volume (13) to a suitable level.
6. To connect to other recording device or PA system, connect it through XLR output.

## TWS INSTRUCTIONS

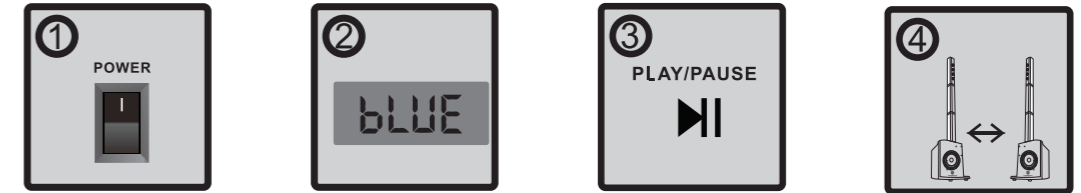

**TWS (True wireless stereo) allows you to play music from a bluetooth device over two PARTY10 pa systems simultaneously.**

### Noted:

1. Make sure each PA system has the "TWS" function. PA systems should be the same model.
2. Under "TWS" function, pa system only can playback music via the bluetooth device.

### Operating instructions:

1. Plug in and turn on the power (19) (20).
2. Press each speaker's MODE button (3) to switch to BLUETOOTH mode.
3. Choose one PA system as master PA system. Long press the main PA system's play/pause button (7) for 5 seconds. Then you will hear ding-dong sound to indicate that systems are synced. Then master PA system's screen will display "br-A" and the second PA system's screen will display "br-B".
4. Pair your bluetooth device to your master pa system via bluetooth.
5. To exit this function, long press the play/pause button (7) for 5 seconds on any PA system. The PA system's screen will no longer display "br-A".

## BLUETOOTH INSTRUCTIONS

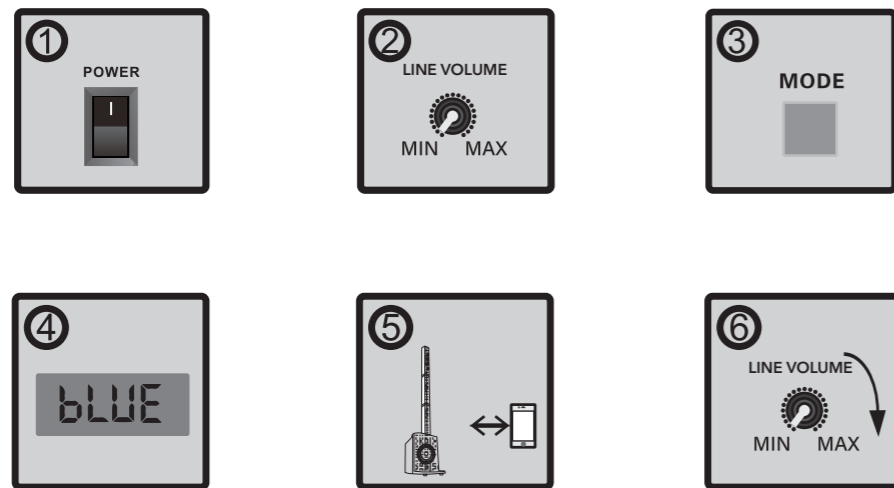

1. Plug in and turn on the power (19) (20).
2. Turn the line volume (13) to the MIN level.
3. Press the MODE button (3) to find "BLUE" on the LCD display.
4. Connect the device. When "BLUE" stops flashing on the LCD display, it means that your device is connected already.
5. Turn the line volume (13) to a suitable level.

**When in BLUE mode, you can connect your bluetooth device, such as pad, phone and PC to the speaker.**

NOTE: Remember to turn up the volume of the connected device to a suitable level for a good sound effect. If there is no sound, please check if you have turned up the BLUETOOTH device volume.

## MIC INSTRUCTIONS

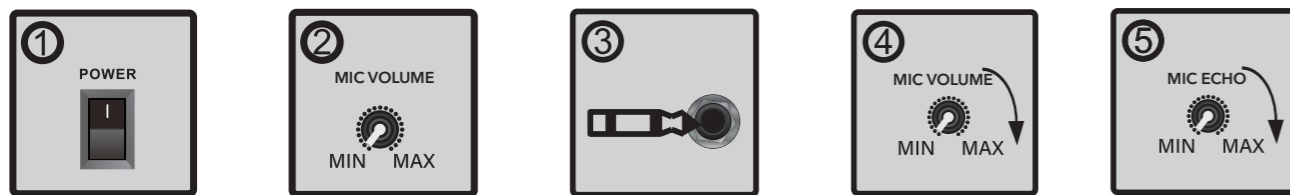

1. Plug in and turn on the power (19) (20).
2. Turn the MIC volume (8) (9) to the MIN level.
3. Connect the microphone to MIC input (11) (12) with a 6.35mm cable.
4. Turn the MIC volume (8) (9) to a suitable level.
5. Turn up the ECHO (10) if needed.

## AMPLIFIER OVERVIEW

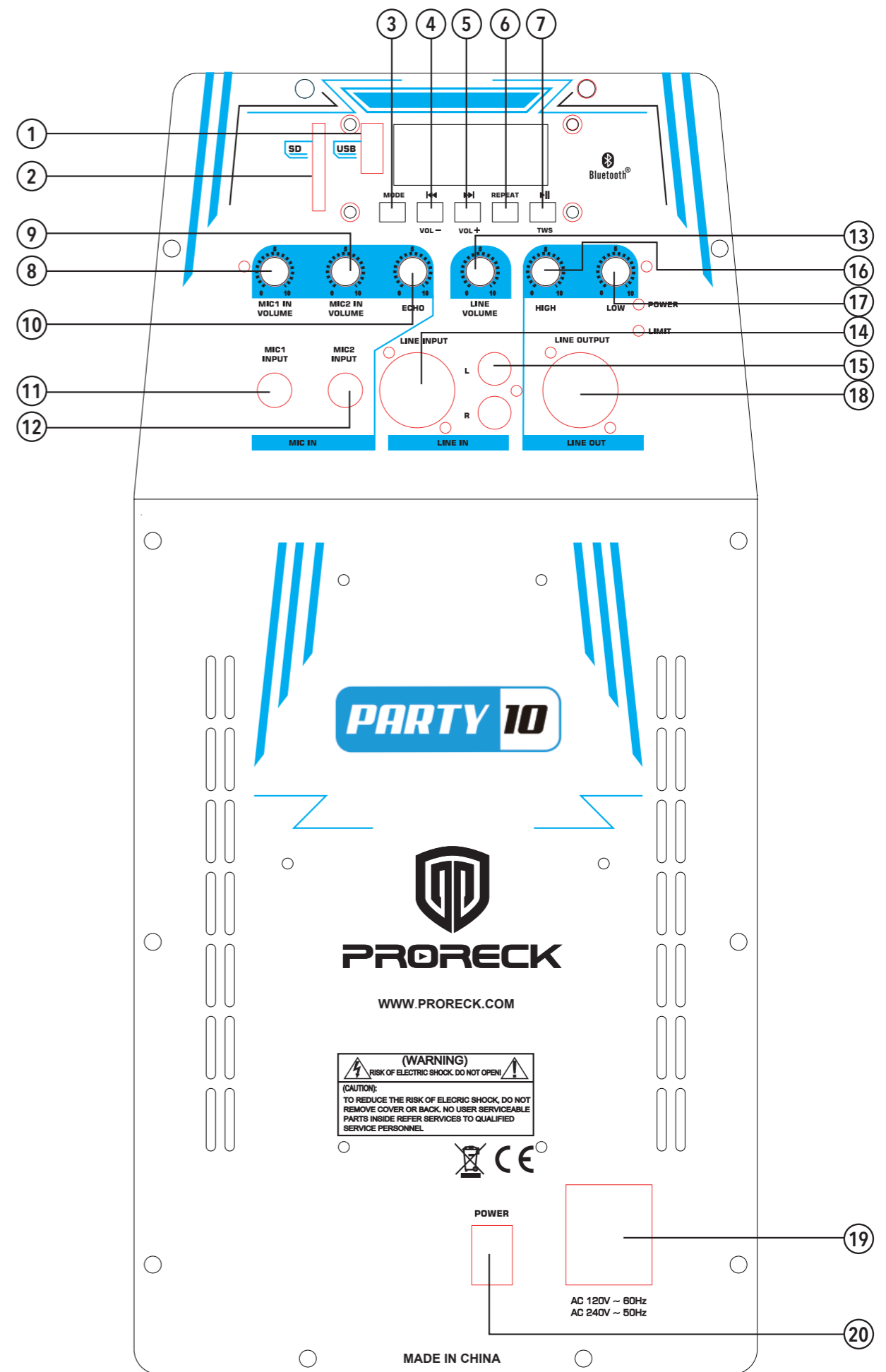

- ① **USB PORT**  
Use it to insert a USB memory storage device with MP3 files.
- ② **SD PORT**  
Use it to insert a SD memory storage device with MP3 files.
- ③ **MODE BUTTON**  
Press this button to switch between BLUE-TOOTH/USB/SD and LINE modes.
- ④ **PREVIOUS BUTTON**  
When using USB/SD/Bluetooth mode, press this button to go back to the previous song. Press and hold to decrease the volume.
- ⑤ **NEXT BUTTON**  
When using USB/SD/Bluetooth mode, press this button to go to next song. Press and hold to increase the volume.
- ⑥ **REPEAT BUTTON**  
When using USB/SD mode, press to select repeat mode. We provide 4 modes: Repeat all/Repeat one/Random/Folder Repeat all. ALL:Means playing all songs in sequence. ONE:Means repeating the current song. RAN:Means playing all songs randomly. FOLD:Means repeating all songs in the current folder.
- ⑦ **PLAY PAUSE**  
Press this button to play or pause the MP3 song when using USB/SD/Bluetooth mode. Press and hold to enter folder mode, the screen will show "FOLD". Then previous button or next button to select your favourite folder. When using Bluetooth mode, press the button to use the TWS function.
- ⑧ **MIC 1 VOLUME CONTROL**  
Use it to adjust mic 1 volume.
- ⑨ **MIC 2 VOLUME CONTROL**  
Use it to adjust mic 2 volume.
- ⑩ **ECHO**  
Use it to adjust ECHO.

- ⑪ **MIC 1 INPUT**  
6.35mm mic input for unbalanced mic.
- ⑫ **MIC 2 INPUT**  
6.35mm mic input for unbalanced mic.
- ⑬ **LINE VOLUME**  
Use it to adjust line input volume.
- ⑭ **XLR INPUT**  
XLR input to connect line-level source.
- ⑮ **RCA INPUT**  
RCA input to connect line-level source.
- ⑯ **HIGH CONTROL**  
Use it to adjust the high level exclusively.
- ⑰ **LOW CONTROL**  
Use it to adjust the low level exclusively.
- ⑱ **XLR OUTPUT**  
Use the XLR output to connect other equipment.
- ⑲ **AC POWER**  
Suitable for AC 120V 60Hz/AC 240V 50Hz.
- ⑳ **MAIN POWER SWITCH**  
This switch controls the AC power going to the PARTY 10 system. We suggest keeping the switch OFF when the system is not being used for an extended period of time.

**WARNING** Use of improper voltage may result in hazardous conditions and damage the PARTY 10, that are not covered by the factory warranty. For your safety, please make sure the subwoofer is not connected to any power source prior to accessing the AC selector and fuse compartment.

## REMOTE CONTROL FUNCTION

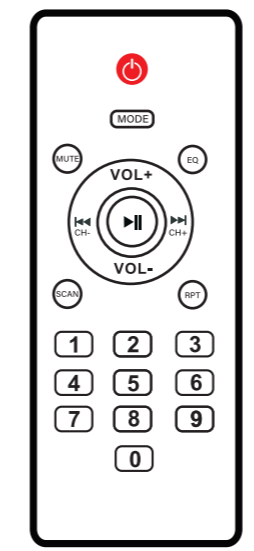

- Press this button to turn off the MP3, If you want to close the whole system, you need switch off the power switch.
- Press this button to switch between USB/SD, Bluetooth and Line mode.
- Press this button to mute the whole device.
- Press this button to select from 6 preset EQs: POP, CLASSIC, JAZZ, COUNTRY, NORMAL and ROCK, when using USB/SD drive function.
- Press this button to go to the previous or next song when using USB /SD mode. Press these buttons to access the previous or next folder when in Folder.
- Press this button to play or pause the MP3 song when using USB/SD mode.
- Press this button to decrease (-) or increase (+) the volume.
- Press this button to enter Folder.
- When using USB/SD mode, press to select repeat mode. We provide 4 modes: Repeat all/Repeat one/Random/Folder.
- Press these number buttons to select the MP3 files when using USB /SD mode.

## APPLICATIONS SD/USB INSTRUCTIONS

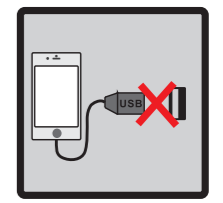
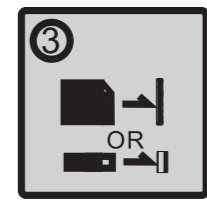
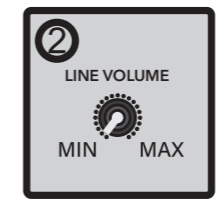
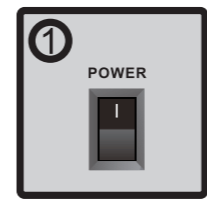
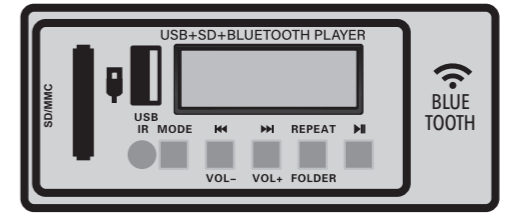

- 1.Plug in and turn on the power (19) (20).
  - 2.Turn the line volume (13) to the MIN level.
  - 3.Insert a SD card or USB drive to the SD port (2) or USB drive port (1).
  - 4.Turn the line volume (13) to a suitable level.
- NOTE: MP3, cellphone, pad and PC can not be read by USB. You may connect them by BLUETOOTH or LINE IN function. If there is no sound, please check if the Line Volume is turned up.