

# 25 牛仔裤扣

# JEANS BUTTON

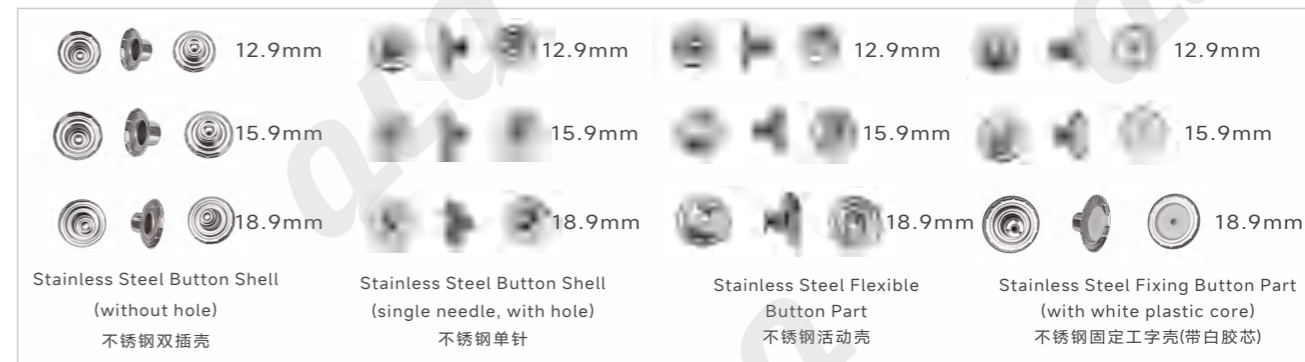

货描 Description	钮口尺寸(mm) Size	面尺寸(mm) Cover Size
常规尺寸 Regular Size  不锈钢工字壳入胶芯 不锈钢活动壳 不锈钢单针 不锈钢双插壳 Stainless Steel Fixing Button Part with Plastic Core Stainless Steel Flexible Button Part Stainless Steel Button Shell (single needle, with hole) Stainless Steel Button Shell (without hole)	12.9	13.8
	15.9	16.8
	16.9	17.8
	18.9	19.8
	14.1	15
	16.1	17
	17.1	18
	18.1	19
	19.1	20



# 26 四合扣之急钮

# SPRING SNAP BUTTON

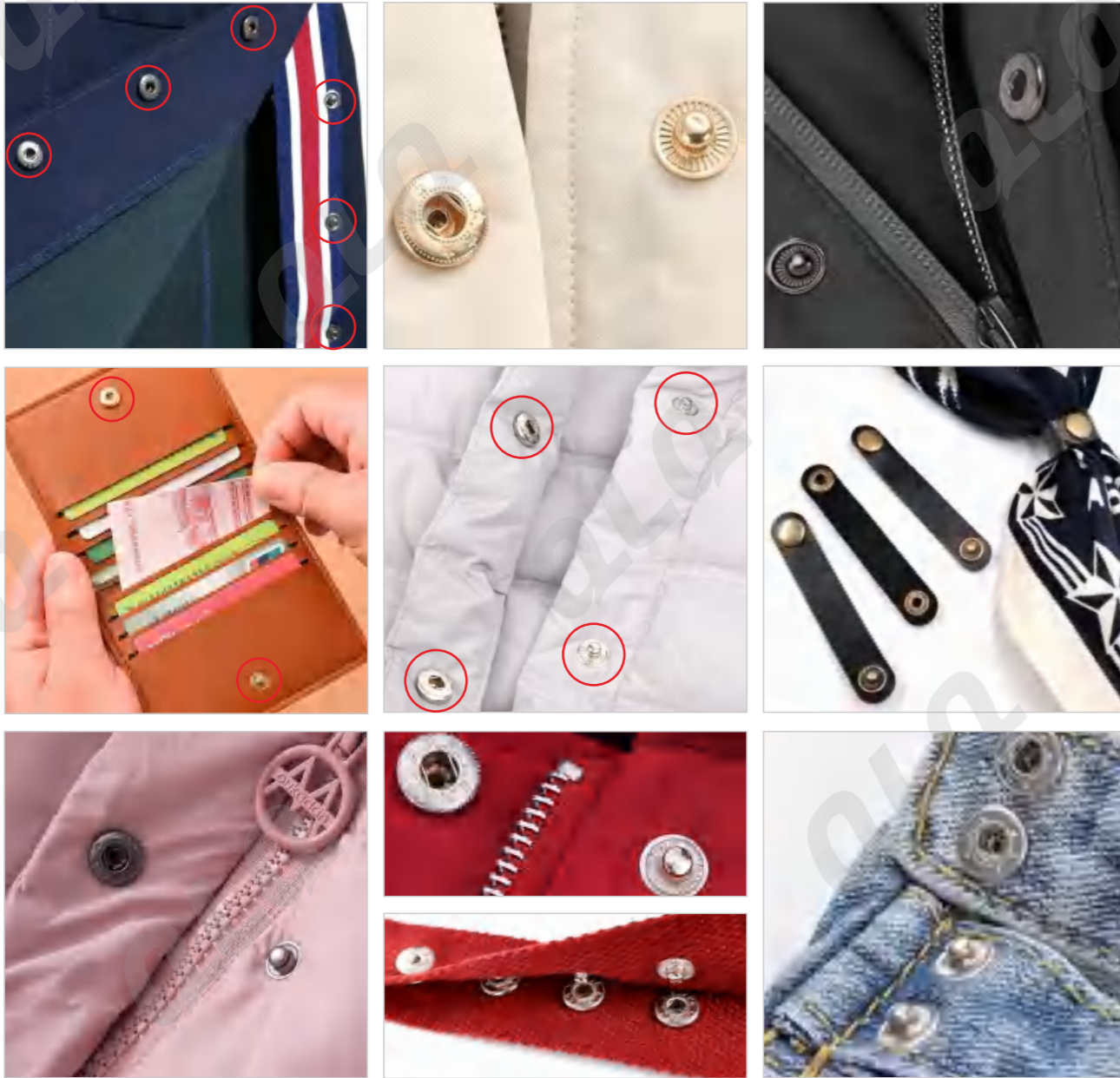

型号 Model No.	面扣(mm) Part A: Cap	弹簧(mm) Part B: Socket	珠头(mm) Part C: Stud	直笛(mm) Part D: Post
688#	8	9	7	7.3
655#	10	10	8.5	8.5
633#	12.5-20	12	10.5	10
831#	15-20	14	11.5	11
8050#	15-20	15	14	12.5

# 27四合扣之车缝钮

## RING / SEWING / BOWL SNAP BUTTON

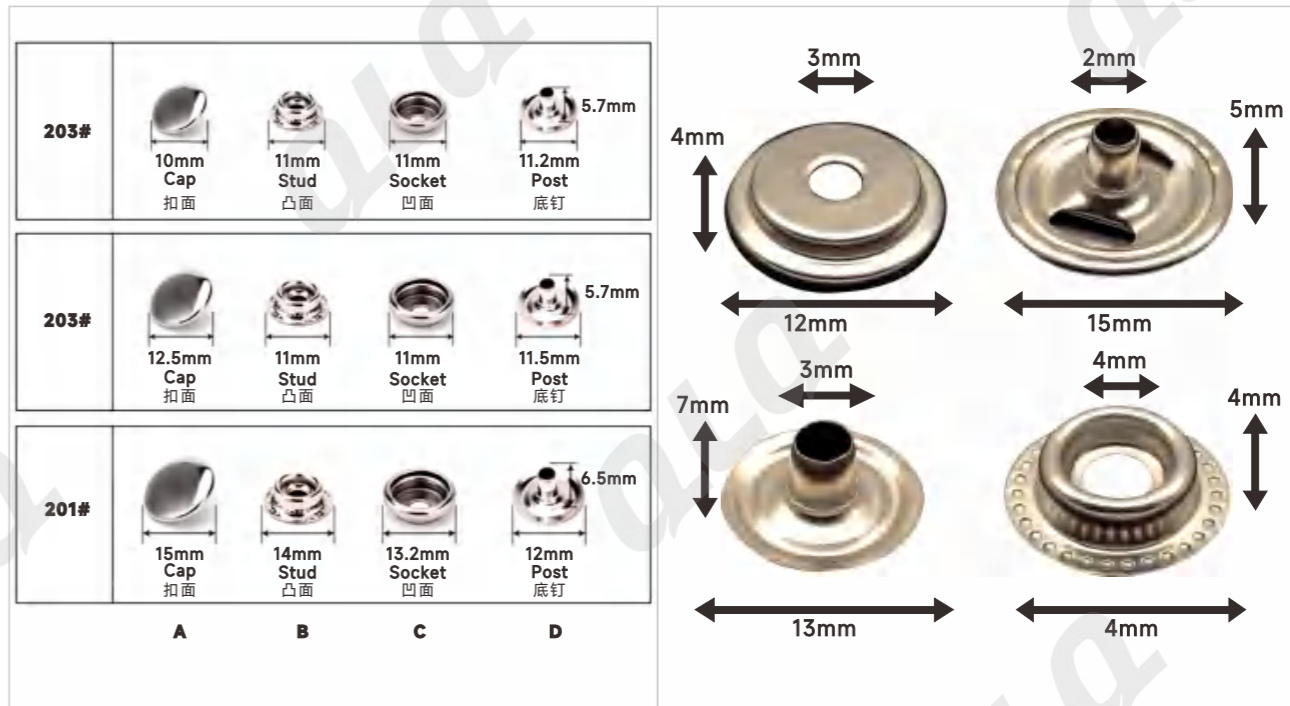
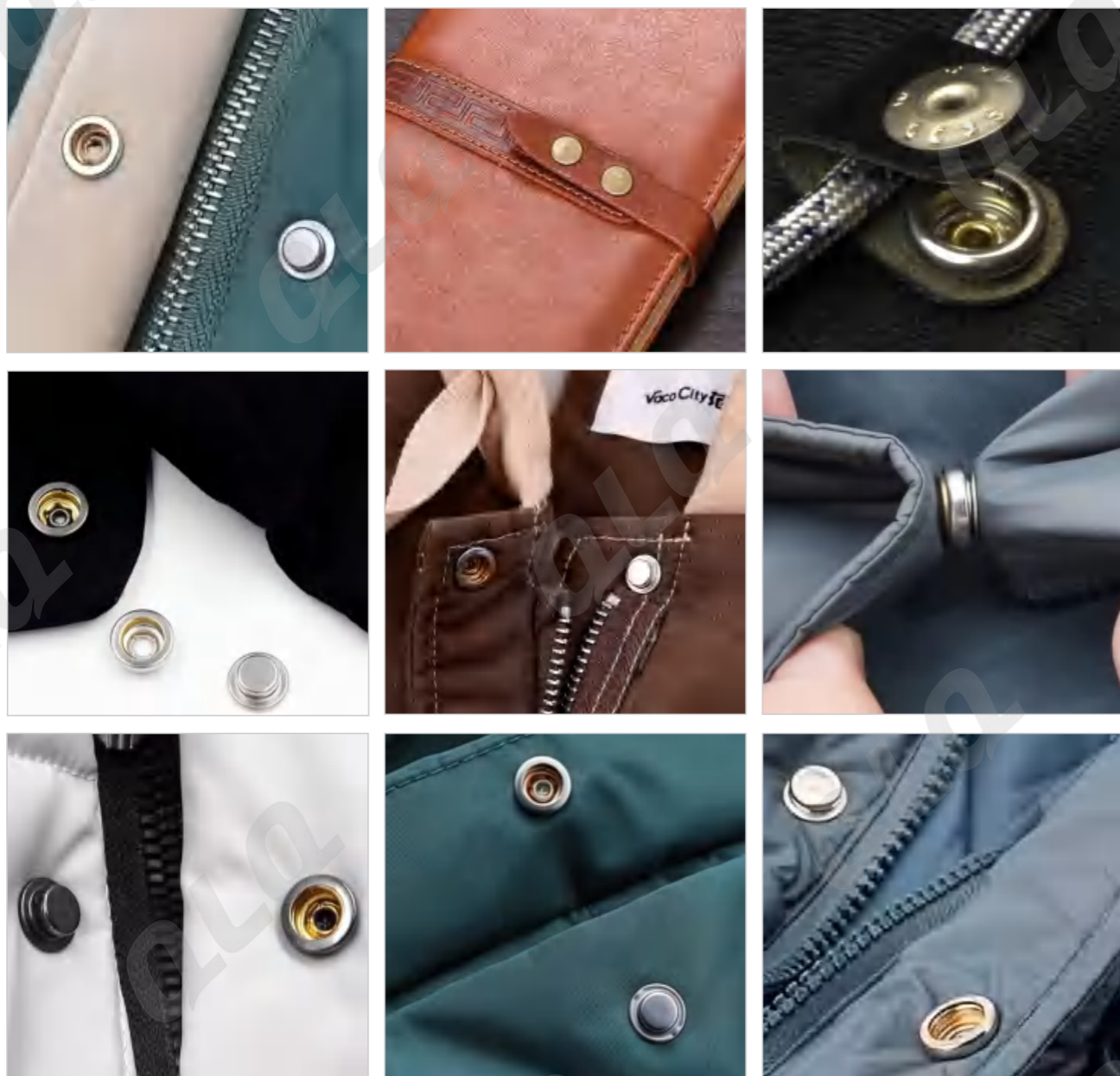

Sizes 1

Sizes 2

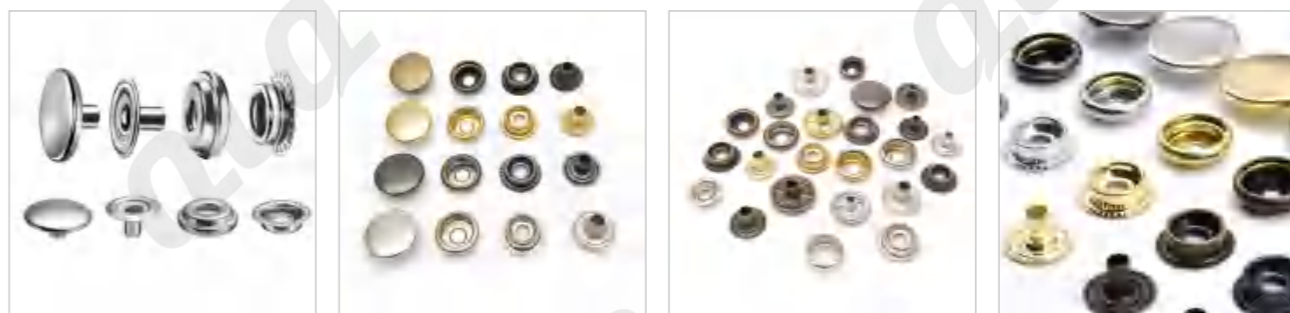

RSB-1

RSB-2

RSB-3

RSB-4



RSB-5 Cap (part A)  
面扣(A)

RSB-6 Stud (part B)  
凸面(B)

RSB-7 Socket (part C)  
凹面(C)

RSB-8 Post (part D)  
底钉(D)

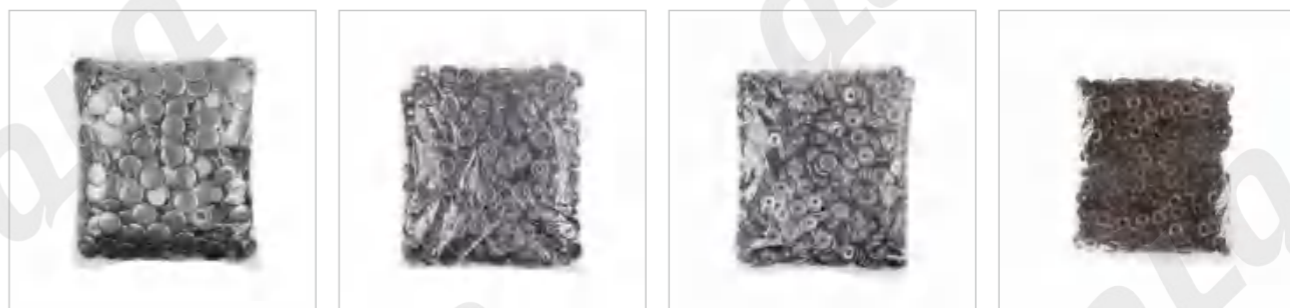

RSB-9 Cap Packing  
面扣包装

RSB-10 Stud Packing  
凸面包装

RSB-11 Socket Packing  
凹面包装

RSB-12 Post Packing  
底钉包装



型号 Model No.	扣面(mm) Part A: Cap	凸面(mm) Part B: Stud	凹面(mm) Part C: Socket	底钉(mm) Part D: Post
203#	10-20	11	11	11.2
201#	15-20	14	13.2	12

# 28 四合扣之五爪钮

# PRONG SNAP BUTTON

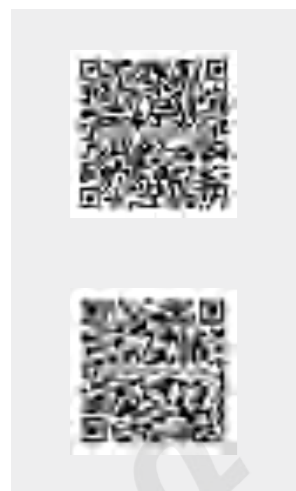

型号 Model No.	单爪 (mm) Part A: Prong	钮珠 (mm) Part B: Stud	八瓣 (mm) Part C: Socket	单爪 (mm) Part D: Prong
111#	7.2	7.5	7.5	7.2
111.5#	7.8	8.5	8.5	7.8
222#	9-9.2	9.5	9.5	9-9.2
333#	10	11	11	10
444#	12.5	13	13	12.5
555#	14	15	15	14
888#	20.8	20.7	20.7	20.8
999#	29	30	30	29

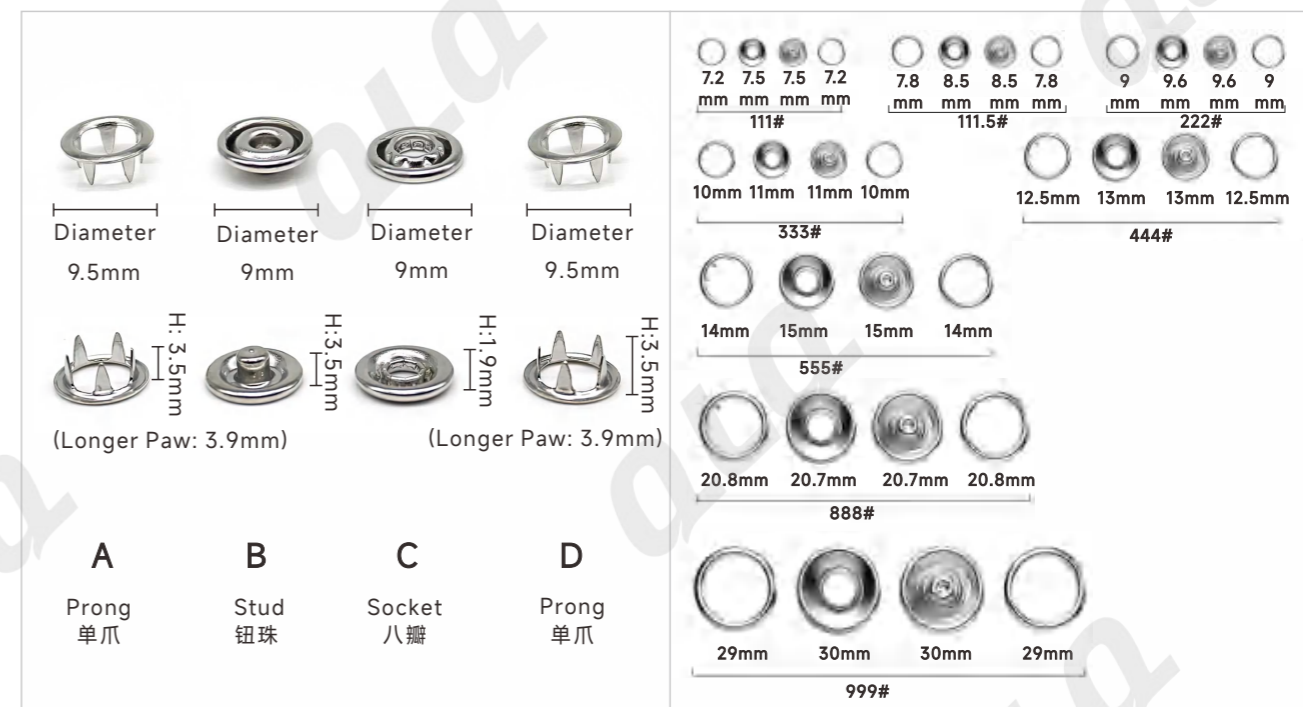



Sizes 1

Sizes 2



RV-1

RV-2

RV-3

RV-4

RV-5

RV-6

RV-7

RV-8

RV-9

RV-10

RV-11

RV-12



货描 Description	尺寸(mm) Size
撞钉 Rivet	5mm 6mm 6.5mm 7mm 8mm 9.5mm 10mm 12mm

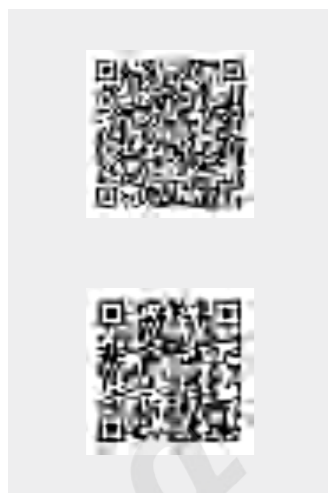
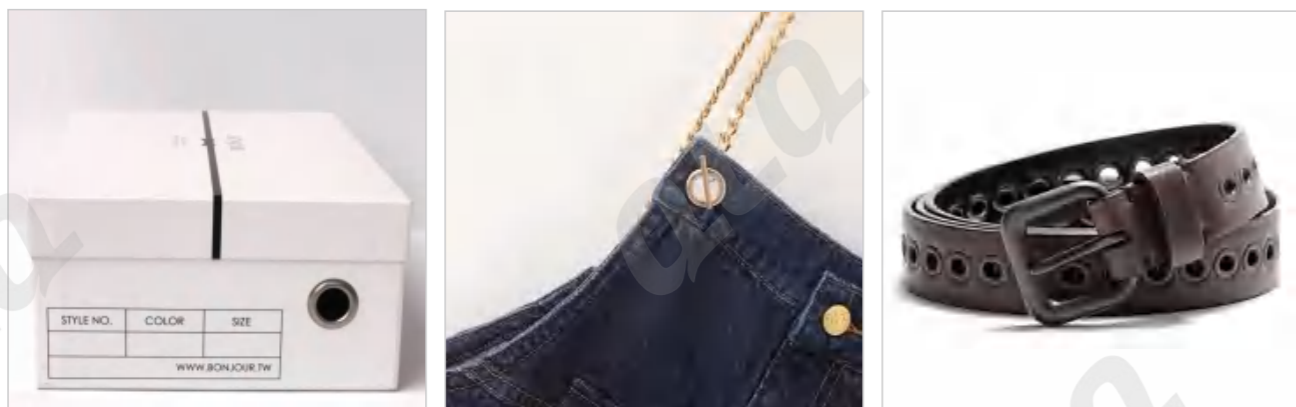

货描 Description	外径尺寸(mm) Outer Diameter	内径尺寸(mm) Inner Diameter	高度尺寸(mm) Height
鸡眼 Eyelet	9	5	5
	9	4.5	4
	8	4	4
	7	3.5	4
	5	2.5	3
	12	6	5
	14	8	5
	15	8	5.5
	17	10	5
	21	12	5
	23	13.5	7
	28	17.5	7

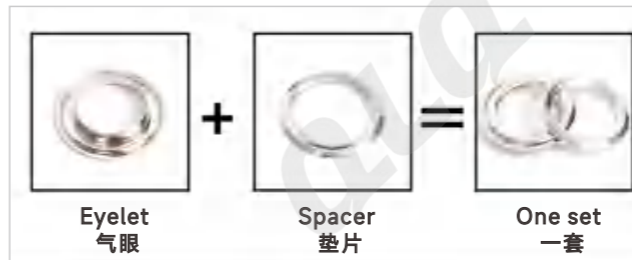

Inner Diameter 内径	Outer Diameter 外径	Height 高度
3.5mm	6.5mm	3.2mm
4.0mm	7.0mm	3.2mm
4.5mm	7.6mm	3.5mm
5.0mm	8.5mm	3.5mm
5.5mm	9.2mm	3.5mm
6.0mm	10.0mm	3.5mm
8.0mm	12.6mm	3.5mm
10mm	14.2mm	3.8mm
12mm	19.0mm	4.0mm
14mm	21.5mm	3.8mm
17mm	26.3mm	5.0mm
20mm	32.5mm	5.0mm

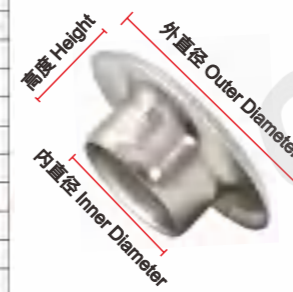

Longer Eyelet 9.5\* 5\* 7,

Hole Inner Diameter: 5mm

Length: 7mm

Cap Diameter: 9.5mm

Sizes 1

Sizes 2

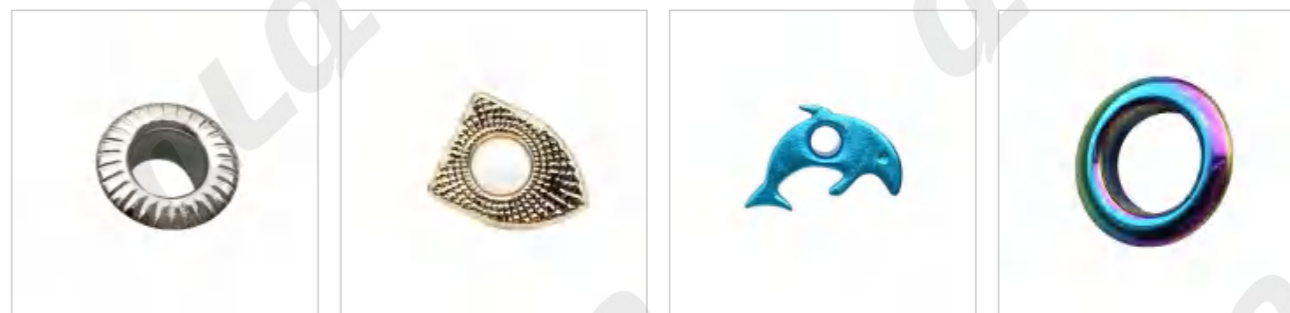

EL-1

EL-2

EL-3

EL-4



EL-5

EL-6

EL-7

EL-8



EL-9

EL-10

EL-11

EL-12

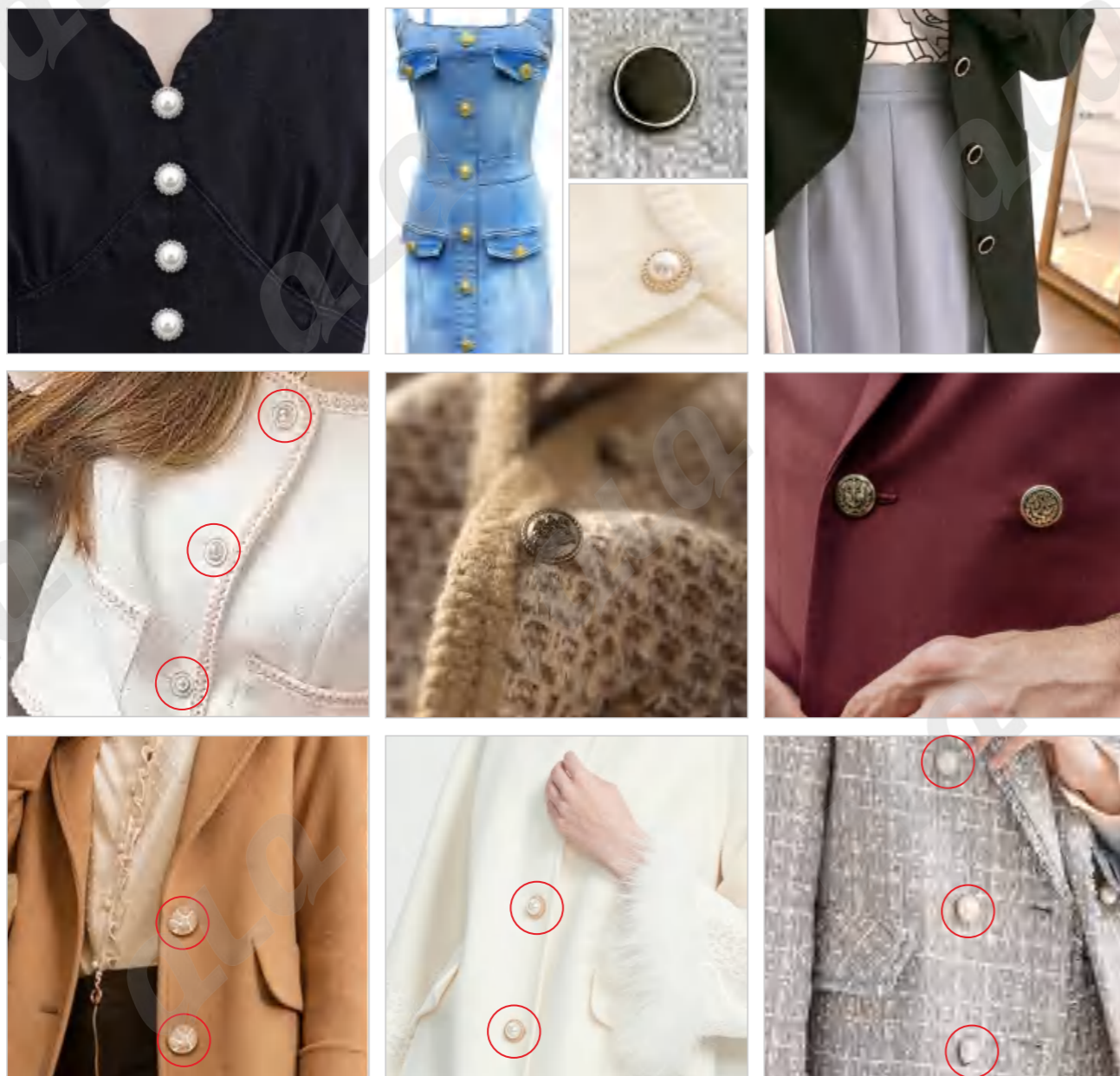

手缝扣、军扣常规尺寸(mm) Regular Size of Coat /Sewing Button	
尺寸 Size	12.8mm,13mm,14mm, 15mm, 20mm, 22.5mm

23mm      25mm      28mm

15mm      18mm      20mm

**Size**

10mm 12mm 15mm 18mm 20mm 23mm 25mm 28mm

10-12mm: Used for shirts

15mm: Used for western suit sleeves

18mm: Used for coat sleeves & leisure western suit sleeves

20mm: Used for front side of western suits

23mm: Used for front side of coats & leisure western suits

25-28mm: Used for front side of coats & windbreakers

Sizes-1

CB-1      CB-2      CB-3

Sizes-2

CB-4      CB-5      CB-6      CB-7      CB-8

CB-9      CB-10      CB-11      CB-12

# 32 两孔四孔扣

## TWO HOLES BUTTON / FOUR HOLES BUTTON



Sizes-1

Sizes-2

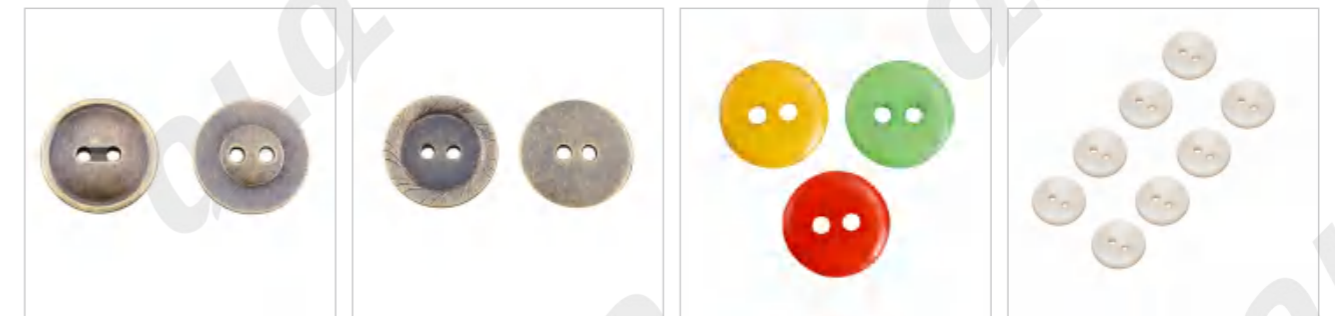

THB-1

THB-2

THB-3

THB-4



THB-5

THB-6

THB-7

FHB-1

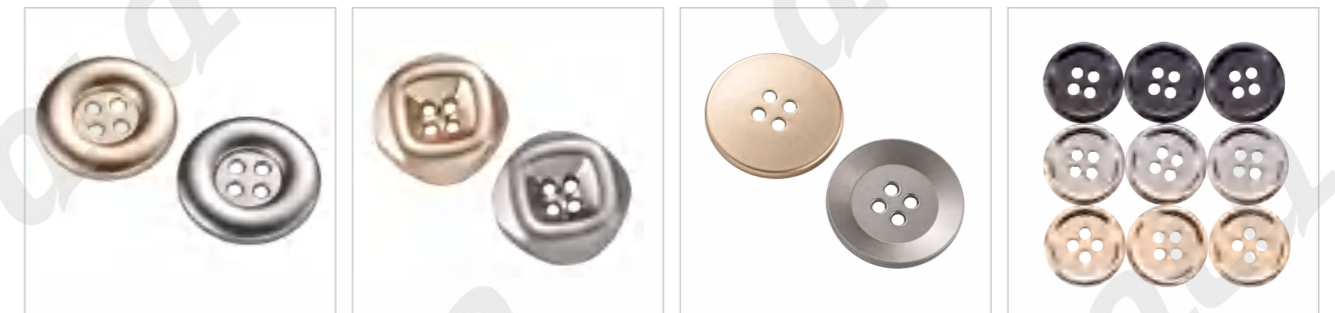

FHB-2

FHB-3

FHB-4

FHB-5

货描 Description	尺寸(mm) Size
两孔扣 Two Holes Button	9mm 9.5mm 10mm 10.5mm 11.5mm 12mm 12.5mm 14mm 15mm 18mm 20mm 21mm 23mm 25mm 28mm 30mm
四孔扣 Four Holes Button	9mm 9.5mm 10mm 10.5mm 11.5mm 12mm 12.5mm 14mm 15mm 18mm 20mm 21mm 23mm 25mm 28mm 30mm





# 33 塑胶四合扣

# PLASTIC SNAP BUTTON



货描 Description	A面(mm) A: Cap	B母扣(mm) B: Socket	C公扣(mm) C: Stud	D面(mm) D: Cap
塑胶四合扣 Plastic Snap Button	10	9	9	10
	12	10	12	12
	14	12	12	12

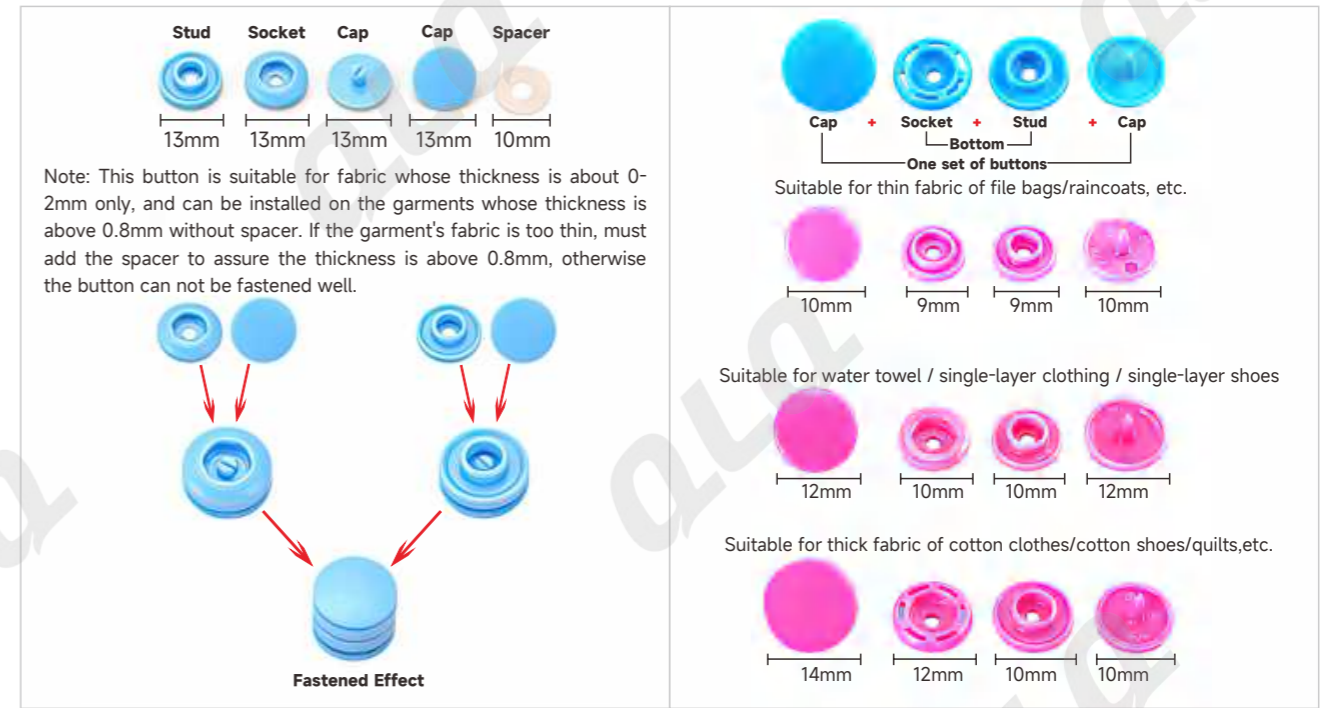

ala QUALITY | LOWER COST | QUICKLY