

Instruction Manual

Basin faucet&Bathtub faucet System



Model:1381



Model:5525



Model:1220



Model:5934

Installation Condition



1.Refer to the 《Standard Part List》 when unpacking ,
check all parts available .



2.Do not disassemble mixer body by yourself.

3.Connect inlet hoses to supply valves.

4.Make sure inlet pipes and supply valves have been
installed and cleaned, also ensure no impurities in
pipeline.

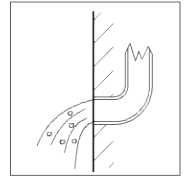

5.After installation , check all joints for leakages.

6.Suggest don't fit the faucet in the severely corrosive
environments.

Sing Basin Faucet Part List

S/N	Description	No.s
1	Body of mixer	1
2	Base installation part	1
3	Flexible hoses	2
4	Fixing nuts	1
5	Use's manual	1
6	Gloves	2

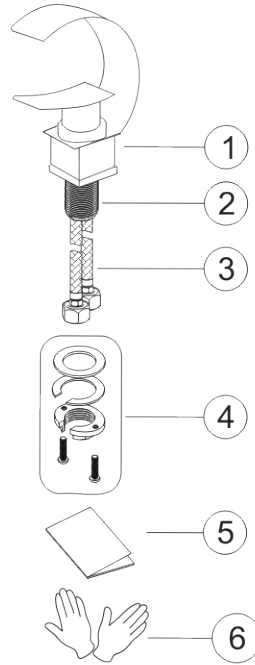

Sing Basin Faucet Installation

step 1

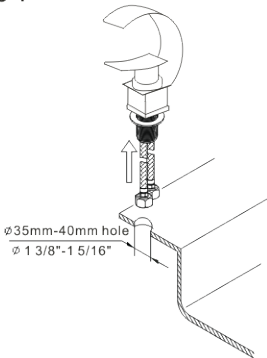

Please make sure there is a hole with $\varnothing 35\text{mm}-40\text{mm}$ ($\varnothing 1\ 3/8''-1\ 5/16''$) on the sink. Then dismantle the fixing nuts from the mixer, and put on the gasket to the base installation parts.

step 2

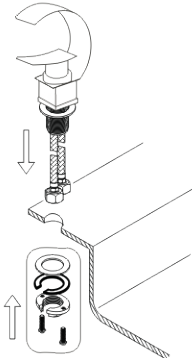

Put the mixer's body with flexible hoses onto the sink through the hole, then assemble the fixing nuts to the tap from the bottom.

Sing Basin Faucet Installation

step 3

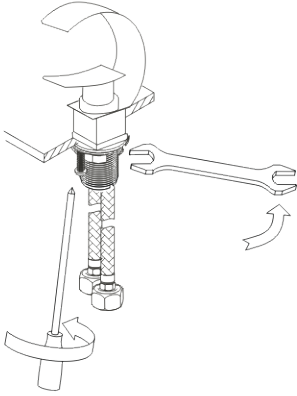

Fasten the fixing nuts by spanner, and tighten the cross screws on the fixing nuts by cross screwdriver.

step 4

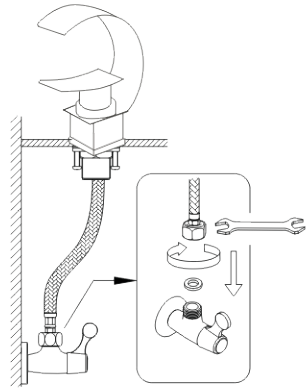

Connect the two flexible hoses to the angle valves . Referring to the red and blue point signals on the handle, please connect them to hot water valve and cold water valve accordingly.

step 5

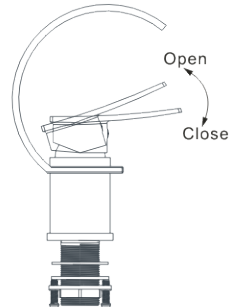
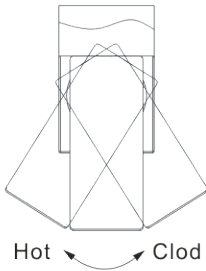

1. Operating handle gradually is better for valve protection.
2. Lift handle will turn on faucet, the wider the lifting angle, the stronger the water flows or vice versa, When handle is lifted, rotating handle lever towards left will allow greater hot water flows, rotating handle lever towards right will allow greater cold water flows.

Care and Maintenance

In order to keep the mixer surface bright , please clean the mixer regularly.

Rinse faucet with clean water and wipe with soft cotton cloth.

Avoid using cleaning powder , harsh cleaning chemicals, brushes, and cloth with coarse surface to prevent scratching and corrosion.

Do not use acid cleaner to clean the faucet as it may cause surface corrosion of the faucet. If the faucet comes into contact with harmful acid substances, please rinse it with water immediately.



If a large-scale clean-up is necessary, follow these procedures:

1: Use clean water and soft cloth to remove dirt on the surface as much as possible.

2: Use one of the following cleaners to remove dirt on the surface

Mild liquid cleaner.

Colorless glass cleaner, powder cleaner which does not have abrasive function and can be dissolved completely.

Polish liquid which does not have abrasive function.

3: After cleaning, remove the cleansing agent with clean water completely and wipe with soft cotton cloth.